



CMCP787A-I

Precision Output Side Exit Accelerometer, Integral Cable



Features:

- Precision Output Side Exit Accelerometer
- 100mV/g $\pm 5\%$ (Standard, Others Available)
- 5 Meter (16') Braided Armor Integral Cable
- Class 1 Division 2 Approved
- Class 1 Division 1 Approved with IS Barrier or Isolator
- -67 to +284°F (-55 to +140°C) Extended Temperature Range
- $\pm 80g$ Range
- 1/4"-28 UNF Captive Bolt
- Sealed to IP65

Typical Applications

Fans, Motors, Pumps, Compressors, Centrifuges, Conveyors, Air Handlers, Gearboxes, Rolls, Dryers, Presses, Cooling, HVAC, Spindles, Machine Tooling, Process Equipment and many more.

Technical Performance

Mounted Base Resonance:	27 kHz (nominal)
Sensitivity:	100mV/g $\pm 5\%$ Nominal 80Hz at 22°C
Frequency Response:	2 Hz to 10 kHz $\pm 5\%$ (120 cpm to 600k cpm) 1.5 Hz to 12 kHz $\pm 10\%$ (90 cpm to 720k cpm) 0.8 Hz to 15 kHz $\pm 3dB$ (48 cpm to 900k cpm)
Isolation:	Base Isolated
Measurement Range:	$\pm 80 g$
Transverse Sensitivity:	Less than 5%

Electrical

Electrical Noise:	0.1mg max
Current Range:	0.5mA to 8mA
Bias Voltage:	10-12 Vdc
Settling Time:	1 Second
Output Impedance:	200 Ohms max.
Case Isolation:	$>10^8$ Ohms at 500 Volts

Environmental

Operating Temperature Range:	-67 to 284°F (-55 to 140°C)
Sealing:	IP65
Maximum Shock:	5000 g
Approvals:	CE Approved CSA/UL Class 1 Division 2, Groups B, C and D

Mechanical

Case Material:	Stainless Steel
Sensing Element:	PZT/Compression
Mounting Torque:	5.9ft. lbs (8Nm)
Weight:	6.5 Oz (185 grams)
Mounting:	1/4"-28 UNF Captive Bolt (Supplied with Sensor)
Mating Connector:	5 Meter (16') Braided Armor Cable, 2 Wire with Drain/Shield

Hazardous Location Ratings

Class I, II, III, Division 1 and 2, Groups A-G, T4, -55°C to + 110°C IP65
Class 1, Zone 0, AEx, ia, IIC, T4, Ga, -55°C to + 110°C
Zone 20, AEx, ia, IIIC, T130°C, IP65, Da, -55°C to + 110°C
Class I, II, III, Division 1, 2, Groups A-G, T6, -55°C to + 110°C
Zone 20, AEx, ia, IIIX, T80°C, IP65, DA, -55°C to + 110°C

Optional Modifications

Non-Stocked Sensitivities: 50mV/g (-050), 250mV/g (-250) and 500mV/g (-500)
Sensitivity specified after base part number (ex. CMCP787A-I-500)

Dimensions

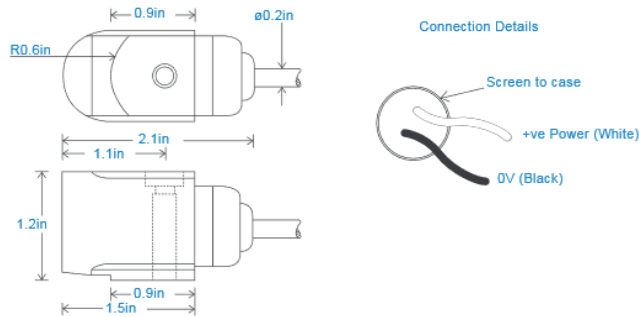

Typical Frequency Response (at 100mV/g)

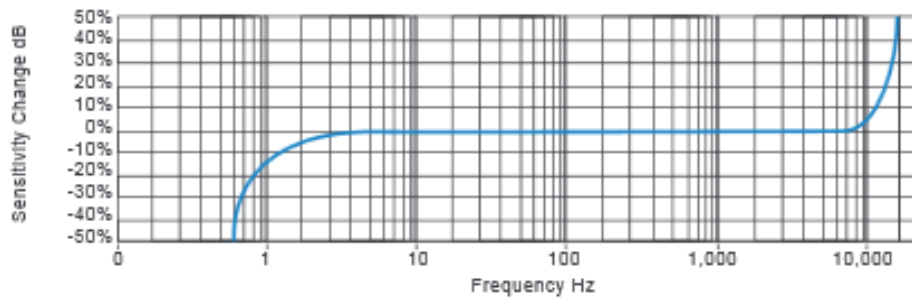

Ordering Information:

CMCP787A-I Precision Output Accelerometer, Side Exit, 100mV/g with Braided Armor Integral Cable

Alternative Sensitivity Ordering Information:

CMCP787A-I-XXX Specify Sensitivity in Place of -XXX
50mV/g (-050), 250mV/g (-250) and 500mV/g (-500)

Similar Products:



CMCP787A
2 Pin MS 5015 Connector



CMCP787A-M12
M12 Eurofast Connector